

CELLRETURN LED MASK **PLATINUM**

User Manual

Model Name

Mask MP-M2134

Cradle MC-D114

—
Make sure to read the
“Safety Precautions”
before use and use it accurately.

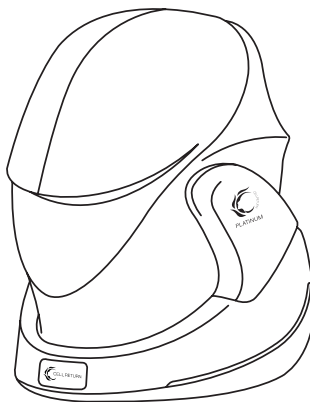

This product is a cosmetic device, not a medical device.

Contents

Precautions on Safety	6
Precautions on Skin Safety	7
Precautions on Product Safety	10
Precautions on Use	
Warnings and precautions on adapter	12
Warnings and precautions on usage	13
Warnings and precautions on battery	14
Warnings and precautions on product storage	16
Product Storage and Management	17
Exemption from Liability	19
Product Use Q&A	20
Before Use	
Features specific to this device	22
Names of each unit	24
Product specifications	25

Instructions

How to use	26
How to operate	28
Battery	29
CELLRETURN LED Mask Platinum Mode	30
How to use the eye shield (for Platinum only)	32
How to replace the cover	34
How to recharge	36
How to install the app and synch with the device	38
CELLRETURN app features	40

Troubleshooting

Checklist before failure report	42
Product warranty	43

Others

Liabilities of charged service (Costs borne by customers)	44
---	----

Precautions on Safety

Please keep the precautions!

Precautions are classified into “Reference,” “Caution,” and “Warning” and they refer to the following:

These symbols are marked to call attention to the operation details that may have a risk of danger if not followed properly. Parts with these symbols must be read carefully and you must follow the according instructions to avoid any danger.

Reference

It indicates the notification of a reference to the function.

Caution

It indicates the case that may run the risk of product damage or mild injury when violating the displayed instructions.

Warning

It indicates the case that may run the risk of product damage or fatal injury when violating the displayed instructions.

After reading the User Manual, keep it in the place where anyone can see any time.

Precautions on Skin Safety

Prohibited



- When the skin condition shows unusual symptoms and when the skin is flushed (ex : after drinking, sunburn, right after outdoor activities such as golf, right after workout, sauna, lower-body bathing, peeling, etc.)
- If you are sensitive to light
- If you are pregnant and breastfeeding When using it together with the cosmetics that contain the ingredients reacting to lights (retinol, vitamin C, BHA salicylic acid, citrus-based oil, etc.)
- When you are taking or using the medicine or cosmetics that cause the skin dryness (ex : Cleocin-T (acne liquid for external use), Roaccutane (sebum control medicine), Retin-A cream (vitamin A derivative cream), Stieva-A cream (vitamin A derivative cream), PAIR acne ointment, diuretic, antihistaminic agent, etc.)

Precautions on Skin Safety

—
For the cases below, consult the medical specialist:



- Cancer patient | Cardiovascular disease | Endocrine system disorder | Sensory nervous system disorder
- Infectious disease | Epileptic disease | Systemic lupus erythematosus
- If you have skin disease
- Eye diseases (ex:cataract, glaucoma, conjunctivitis, sty, etc.) and surgeries (ex:LASEK, LASIK, etc.)
- If you are taking any medicine due to hormonal imbalance
- If you have any other diseases or disorders and have any signs of disorder in your body
- If you have any inquiry, contact the retailer.

Caution!



Keep out of reach of the children and do NOT let them operate the device.



Take off lenses and glasses before using the device.

Precautions on Product Safety

How to use the product safely?

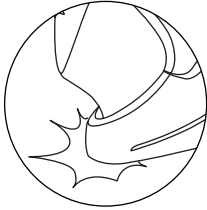

Do NOT apply heavy weight or impact on the device. Do NOT randomly separate or modify the inside of the device.



Do NOT use the device with wet hands or store it in the place close to moisture as the device is vulnerable to a damp environment.

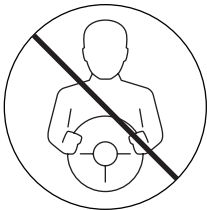

Do NOT use the device while driving or walking. Do NOT use the device while driving or walking.



Remove any jewelry on the area that the device touches before using it.

Caution

Be careful not to connect the mask, the cradle and the charger at the same time. (Charge separately)

Cautions

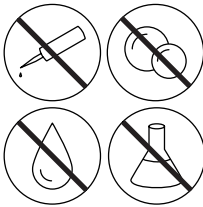

Do NOT rinse the device with water or wipe the device with oil or alcohol (strips off the coating film).



After using the device, wipe with the included cleaner towel for storage.

1. When charging or using the product (or using it continuously), one side of the mask may get heated, but it does not mean the defect in the product.
2. If there is any sign of abnormality while using the product, contact the retailer.

! Reference

- If you want to know more about the detailed usage of mask depending on your skin condition, contact the retailer.
- Do NOT radiate the device light to pets or other objects.

Precautions on Use

Warnings and precautions on adapter

Warning

- Do NOT use or recharge by placing it on top of a blanket, electric pad, or carpet.
 - It may cause fire or failure due to the increase of internal heat.

Caution

- If there is any smoke or unusual odor, discontinue use. Immediately turn off the power, pull out the charging adapter and contact the service center.
 - If you continue to use it, it may cause fire or electric shock.
- Do NOT damage, process, bend, twist, or heat the charging adapter or USB cable.
 - as it may cause fire and electric shock due to the cord damage.
- Do NOT put a conductor such as chopsticks into the groove on the other side while the charging adapter is connected. In addition, do NOT touch the charging adapter right after pulling it out from the outlet.
 - as it may cause electric shock.
- When pulling out the charging adapter from the outlet, hold the main body of the charging adapter to pull out.
 - When pulling the cable by hand, it may cause breakage or short circuit.
- Do NOT soak the charging cradle into water or wash it
 - as it may cause fire and electric shock.
 - Wipe with a dry cloth or tissue.

—
Warnings and precautions on usage

⚠ Warning

- Do NOT disassemble, repair, or modify the product
 - as it may cause fire, electric shock, injury due to malfunction.
- Be careful that the product contains the magnetic material, which may affect the credit card.
- Handle the power plug with dry hands
 - as it may cause electric shock.
- Do NOT drop the product or give impact to the product.
 - Keep the product away from the place with too much vibration or magnets.
- When pulling out the cable plugged into the main body, do NOT hold the cable line but make sure to hold both ends of the cable.
 - Injury may occur due to cable, or the device may drop and result in a failure.
- Please be careful when transporting the product.
 - Injury may occur due to drop.
- Please be careful when using it in a dry environment.
 - Using it in a dry environment may cause static electricity.
 - Use the product after touching the metal object to prevent static electricity.
- Keep away from fires and flames.
- Do NOT use or store the inflammable materials near the product
 - as it may cause explosion or fire.
- Do NOT use any product which applies the high voltage electricity near our product. (ex : electric mosquito swatter)
 - The product may have a failure due to electrical shock.

Precautions on Use

— Warnings and precautions on battery

Warning

- When the battery is damaged, it has a risk of explosion.
 - Do NOT give a shock the product or put it in water, or do NOT store and place it in a car or sauna for a long time.
 - The built-in battery cannot be separated or replaced on a customer's own discretion, and if the battery is not exchanged properly, it has a risk of explosion.
 - Do NOT randomly dispose of the battery, but follow the disposal procedure of the relevant zone.

Warnings and precautions on battery

Caution

- The battery is included in the product. Fully charge the battery for the initial use after purchase.
- The battery is a consumable, so the duration of available hours gradually decreases after a prolonged use.
- The charging time may vary depending on the remaining quantity, surrounding temperature, or charging condition.
- The built-in battery cannot be separated or replaced on a customer's own discretion, and if the battery is arbitrarily separated, a free follow-up service cannot be provided.
- When you need to separate or replace the battery, make sure to use the designated service center.
- The service fee is charged for battery detachment and replacement.
 - * If you have any inquiry on battery replacement, please contact the retailer.

- After electrical discharge, it takes 3 hours to be fully charged.
- Power consumption while charging : 9W
- Cradle power consumption after fully charged : 1W
- 3-hour charging + 21-hour on cradle for a day : Power consumption for one month is 1.5KW

Precautions on Use

Warnings and precautions on product storage

Warning

- Keep away from the direct sunlight or heating equipment.
 - as it may cause fire..
- Do NOT store in the place with heat such as electric heat.
 - as it may cause fire and failure..
- Do NOT store it in the place with too much moisture, dust, or burn.
 - as it may cause fire and electric shock..

Caution

- Keep away from the direct sunlight.
- Do NOT put it in the place with too high (over 35°C) or too low temperature (below 5°C) and too much moisture. (Do NOT store it in the place with high/low temperature and high humidity)

—

Product storage and management

- Do NOT drop the charging adapter into (places like) a drain or sink, or do NOT place or store it in any place that you can drop into, such as water or other liquids. Do NOT use the charging cradle during shower or soak it in the water.
- Do NOT touch the charging cradle or cable soaked in water and detach the charging adapter immediately.
- Close supervision is needed to prevent children from operating the product.
- Keep away the cable from the heated surface.
- When not in use for a prolonged period of time, charge the mask at least once every 3 months to maintain the battery life.
- Do NOT poke the gaps of the product with the pointed metal objects such as keys, hairpins, necklace, and nails.
- Store it in the packing box and if the product transportation is needed, pack it again in the packing box provided with the product purchase.
- Do NOT place the volatile liquid such as pesticide.
- If you wipe the surface of the product too hard, it may damage the product.

Precautions on Use

— Product storage and management

- Do NOT let the product in contact with a plastic product or rubber for a prolonged time.
- Wipe the mask with a soft and dry cloth (non-waterproof) for hygienic storage.
- Wipe only the contaminated area with wet issues. Do NOT use strong chemicals such as alcohol, benzene, and thinner as it may deteriorate the product surface.
- Do NOT put it in a dishwasher, oven, or washing machine.

—
Exemption from Liability

- The manufacturer does not hold any accountability for problems or damage on the product due to user's negligence or careless operation.
- The information of the user manual is written based on the current product specifications, and the contents may vary in parts.
- The manufacturer is updating the new function additionally, and it will continue to apply new technologies.
- All the specifications and functions can be changed without the prior notice to users to improve the performance.

Product Use Q&A

Product Use Q&A

Q What kind of cosmetics should I use when wearing a mask?

A After thorough cleansing, gently apply the toner or lotion on the bare face or when feeling dry.

Q Can I use it while I'm wearing sunscreen?

A CELLRETURN LED MASK is not a device to radiate the UV rays, so there is no need to apply sunscreen. If have applied sunscreen for outdoor activities or worn makeup, thoroughly cleanse first and gently apply the toner and lotion on the bare face or when dry for a better effect.

Q Can I use it after a surgery/cosmetic procedure?

A If you had any cosmetics surgery or skin-related surgical procedure, consult the retailer before use.

Q Can I use all three modes in one day (Red, Blue, Pink)?

A You can use all three modes and daily 20-minute use is recommended.

Q How do I wipe inside the mask?

A Wipe the mask with a soft and dry cloth (non-waterproof) for hygienic storage. Wipe only the contaminated area with wet issues.

Before Use

Features specific to this device

CELLRETURN LED effect: Complex benefits of Red+Near-infrared ray/Blue/Pink deliver the energy

CELLRETURN CO.,Ltd acquired the LED module patent for promoting effective wavelength output on the skin through prolonged research.

Easy and convenient use (fast mode/wireless touch function/wireless charging function)

Daily 9-minute care provides quick and easy use, while wireless charging allows you to easily charge and use. A wireless touch method by touching the power on the head without the need for separate controller makes it easy to control and handy to use.

CELLRETURN product app

It provides smart skin care by recording the duration of use, date, and changing status.



Before Use

CELLRETURN LED MASK PLATINUM

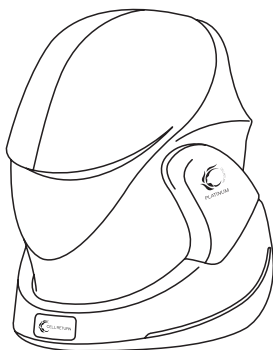

— Side

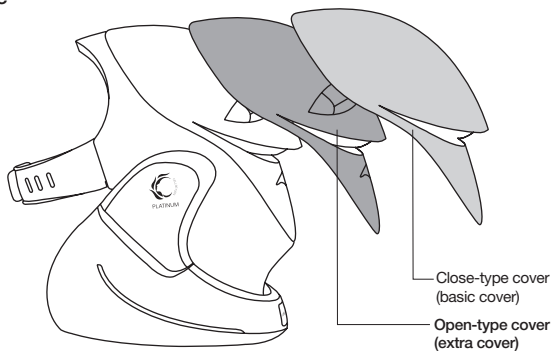

Names of each unit

**—
Front**

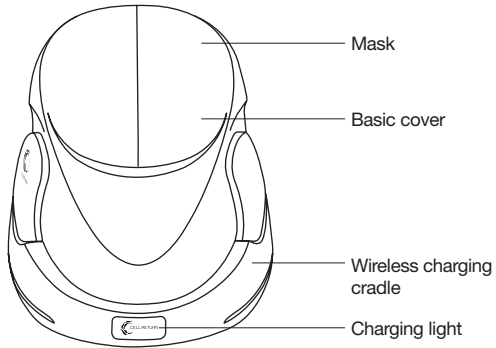

**—
Back**

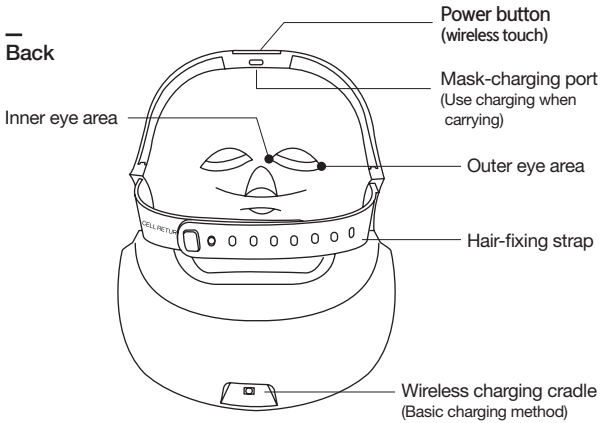

Before Use

Product specifications

Product Name	CELLRETURN LED MASK PLATINUM
Device Name	Specific low power output wireless device
Model Name	MP-M2134
Input Power	DC 5V / 2A (USB C-type)
Built-in battery	Lithium Polymer 3.7V/ 2000mAh
Bluetooth	4.0 BLE
Wireless charging	Qi (Rx)
Size	22.3(W) x 31.4(H) x 17.2(D) cm
Weight (Error range : ±5g)	Main body: 690g Close-type cover:155g/Open-type cover:144g
Manufacturer/ Country of Manufacture	CELLRETURN CO.,Ltd/Republic of Korea

* There is a possibility of radio wave interference during operation of this wireless device.

Product Name	Wireless charging cradle
Device Name	Weak electric intensity wireless device
Model Name	MC-D114
Input Power	DC 5V/2A (DC Jack type)
Wireless charging	Qi (Tx)
Size	26.8(W) x 18.2(H) x 24.0(D) cm
Weight (Error range:±5g)	685g
Manufacturer/ Country of Manufacture	CELLRETURN CO.,Ltd / Republic of Korea

* Design and product specifications can be changed without the prior notice.

Components



Mask



Wireless
charging cradle



User Manual



Cleaner Towel



Open-type cover/
Close-type cover



Warranty Card

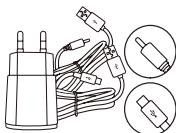

Charger + USB C-type
cable + DC jack-type cable



Eye Shield



Dust bag

Instructions

How to use the CELLRETURN LED Mask PLATINUM

1



After thorough cleansing, gently apply the toner and lotion on the bare face or when feeling dry.

2

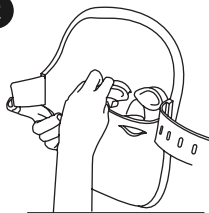

After wearing the eye shield, close your eyes to use.

We recommend 20 minutes of use a day and more than 3 times a week, and it can also be used daily depending on your skin type.

! Reference

- Before using the device, check if it is fully charged.
 - When using this device, skin irritation in various forms may arise depending on each individual's skin condition.
- If there is any irritation like this, adjust the number of use and time.

How to use



- Select the mode you want by the touch sensor on top of the head on your mask. ▶ 20 minutes after auto-termination, moisten cotton pads with a toner and smooth out your skin texture.

Apply the cosmetics or moisture pack that you have been using for good moisturizing.

Caution

- Do NOT look directly at the operating LED light with bare eyes in the near distance.
- Adjust the duration and the number of use depending on the skin condition (sensitive skin, troubled skin)
- If you have any skin disease or have been taking any medicine for a prolonged period, contact the retailer before use.

Instructions

How to operate the CELLRETURN LED Mask PLATINUM

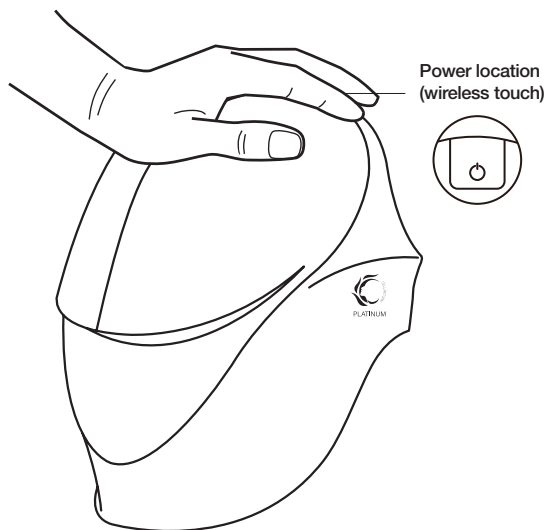

How to touch

Press and hold the touch sensor on top of the mask head for about 2 seconds with the wireless touch when using the CELLRETURN LED Mask Platinum. It may not operate with finger taps or a short touch.

Round 1 - Red Mode (red wavelength + near-infrared ray)

Round 2 - Blue Mode (blue wavelength)

Round 3 - Pink Mode (red wavelength + blue wavelength)

Round 4 - Fast Mode (Red Mode (7 min) ► Blue Mode (1 min) ► Pink Mode (1 min))

Round 5 - Termination

Battery

Battery is included in the mask. The time to fully charge the wireless or wired device is 3 hours starting from discharge, and it can be used 3 times in a row for Red Mode when it is fully charged. When not in use, it may be discharged due to power consumption, so make sure to place it on the wireless cradle all the time. The mask may get heated during the operation of the control board.

* It does not work while charging. Detach the charger for use.

* Please use the enclosed charger.

Instructions

CELLRETURN LED Mask Platinum mode

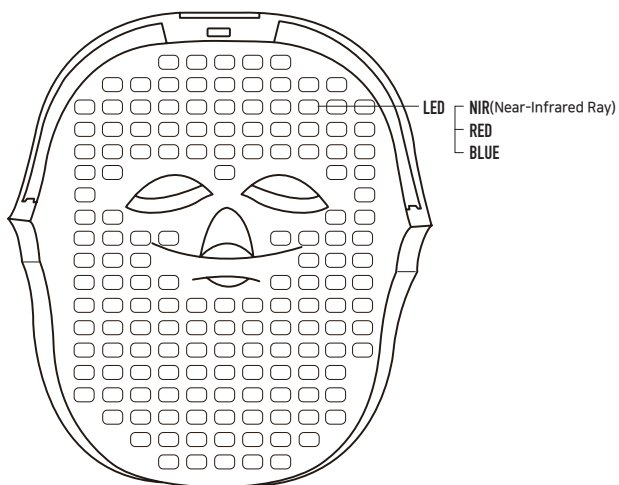

Mode - Red Mode/Blue Mode/Pink Mode/Fast Mode

How to select LED mode

Select the mode suitable for your skin type and it automatically terminates after use.

Auto-termination after 20 min - Red Mode/Blue Mode/Pink Mode

Auto-termination after 9 min - Fast Mode

It can also take care of the outer facial lines.

It is designed to cover the outer facial lines (hair line & neck line).

Use it by matching the area of your eyes and nose.

* Whether the product touches the face or not,
the effects of LED radiation are the same, so rest assured.

Before going out, if you are running out of time, CELLRETURN is here to help you.

Fast Mode, which provides skin care at a short period of time,
helps with skin care of busy modern people.

- Select the Fast Mode with the touch sensor (4 times) on top of the mask's head.
- Three modes of Red, Blue, and Pink change automatically and it automatically terminates after 9 minutes of use. Smooth out the skin texture with moistened cotton pads.

Instructions

How to use the eye shield

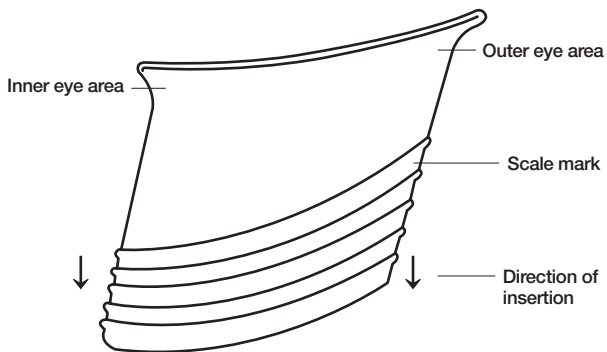

* It is safe to use as it is made of the silicone material not harmful to human body.

— **CELLRETURN** thinks about the safety of our customers. —

After wearing the eye shield, close your eyes to use.

How to use the eye shield

How to fix the eye shield

1

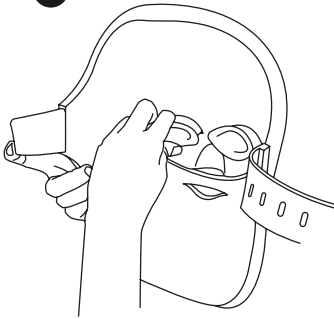

Insert the eye shield into the eye area
on the inner side of the mask.

2

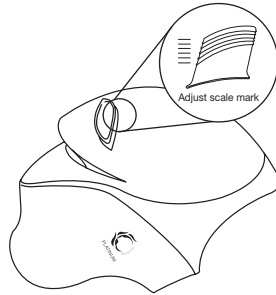

Adjust the scale mark along the
facial curves.

How to clean the eye shield

1. Take off the mask from the eye shield.
2. Use a neutral detergent and rinse under running water.
3. Dry it in a cool place away from the direct sunlight before reuse.



Instructions

— Cover configurations

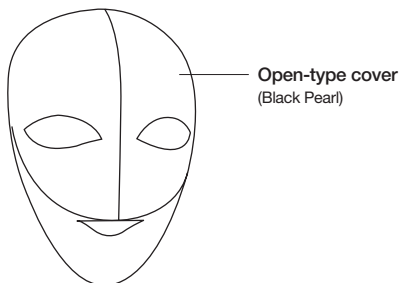
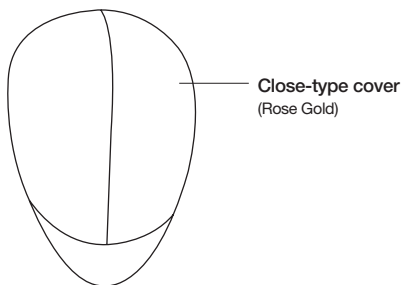

* It can be used without the rose gold or black pearl cover.

How to replace the cover

How to replace the cover

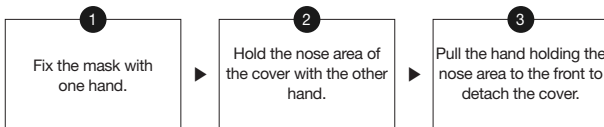
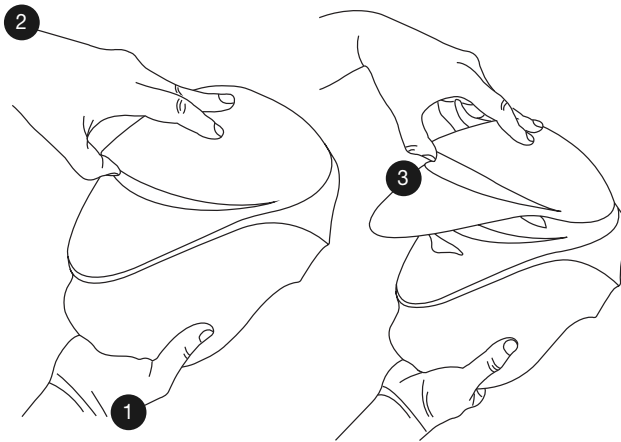

* If the cover is deformed/damaged due to customer negligence, it cannot be compensated.

Instructions

How to do wired charging

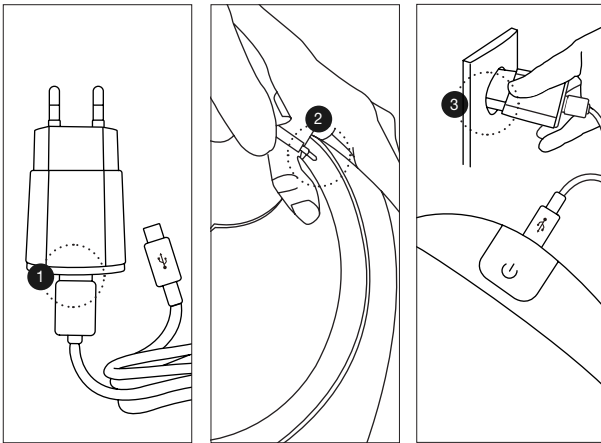

* The mask does not work while charging.

-
- 1** Connect the USB C-type cable to the charger.
 - 2** Check the charging port on the inner side of the mask head and connect the charger.
 - 3** Plug in the charger to start recharging.

* If it does not recharge even after checking this point, please contact the retailer.

How to recharge the mask

How to do wireless charging

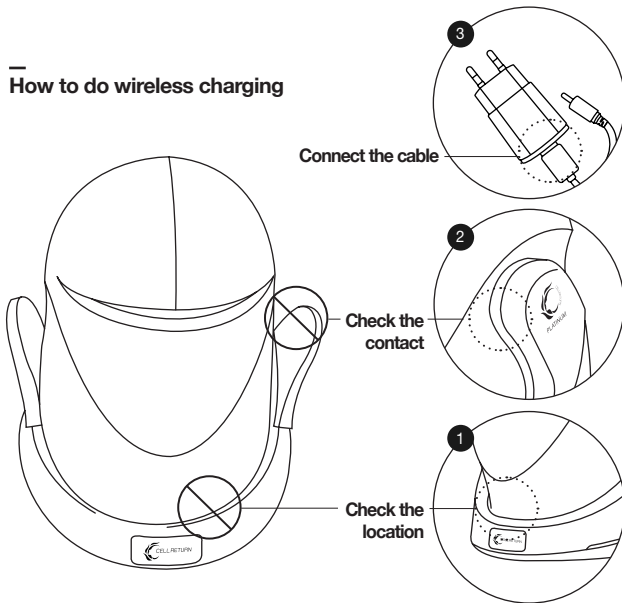

-
- 1 Check if the mask is well-mounted into the groove of the lower cradle.
 - 2 Check if the both wings are attached to each cheek area of the mask.
 - 3 Connect the DC jack-type cable to the charger and plug in to start charging.

* If it does not recharge even after checking this point, please contact the retailer.

Instructions

How to install the app and synch with the device

(If you have any inquiry during installation, contact the retailer.)

1. Log in after installing the app.

2. Register the product.

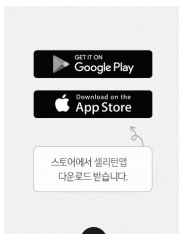

App download

Search the CELLRETURN app on Play Store (Android) or App store (iPhone) on your mobile phone and start downloading.

tip!

For the initial use after installing the app, membership sign-up is needed.

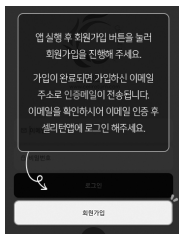

Member sign-up

Membership sign-up is available after entering the personal information and email verification.

tip!

Email verification is needed for membership sign-up.



Device registration

Press the "+Register the device" button in the middle of the app and the button on the upper right side on the app to register the device.

* The app image is for illustration only, and it may vary depending on version.

How to install the app and synch with the device

3. Connect the device



Barcode registration button
Register serial number/
barcode

Register the serial number attached on the product warranty card or read the barcode to register the product.

tip!

Check the serial number (displayed on the product box) in advance or check the warranty period card (inside the enclosed envelope)



Connect the device

Press the connection button on the list of "My device" to synch with the device.

tip!

During the initial connection, connect the device while the power of the device is on.

4. Product control



Remote control function

Platinum mask control is available through the remote control function.
(When controlling the volume, it can be controlled while the device power is on.)

tip!

You can easily control the power switch, volume, and mode of the connected device with the app.

Instructions

CELLRETURN app features

(If you have any inquiry during installation, please contact the retailer.)



Usage history by month

You can check the history by day/month.

Registered product

It displays the registered product and provides the device information verification and tip. Select Gallery on the upper left side to record the changes of your skin.

Calendar

Check the number of days achieved (over 20 minutes or 9 minutes of Fast Mode usage history) on the calendar for checking.

Usage history by day/month

You can check the history by day/month at a glance.

Other features

Gallery : You can check the change in your skin through gallery's image.

* The app image is for illustration only, and it may vary depending on version.

CELLRETURN app features



Point

The accumulated point can be used on CELLRETURN Point Mall in Korea.

Point

You can check the total point.

Recent point accumulation history

Accumulated point is displayed in the order of date and time.

Point Mall

List the products you can buy with point.

Troubleshooting

Check before failure report.

Symptoms	Countermeasures
The product does not work properly.	<ul style="list-style-type: none">· Check if the power button is pressed properly.· Charge the device according to the directions in the user manual.· When charging the device, check if the battery status light is on.
The power does not turn on.	<ul style="list-style-type: none">· The battery is dead.<ul style="list-style-type: none">- Charge the battery.· Connect the charging adapter to the power supply device.· Check if the charger works.· Check if the voltage displayed on the device applies to the main voltage of your area.· Connect the device to the charger directly to check the operation.
It has too much heat.	<ul style="list-style-type: none">· It may be heated temporarily due to a large amount of charging, and if the remaining charging is filled up, it cools down gradually.· It is a natural heating sensation that occurs due to the control board operation.
When charging, the charging light does not turn on.	<ul style="list-style-type: none">· Check if the device has been properly mounted to the cradle.· After the battery has been dead for some time, the charging light does not turn on right away.
LED light looks dim.	<ul style="list-style-type: none">· If LED light looks dim, charge and check again.

Product warranty

Free repair warranty period after purchase : **12 months**

Retention period of major parts : **6 years**

Warranty period of product quality: **12 months**

Warranty period of battery quality: **6 months**

* Please keep the product quality warranty card with the purchase date in a safe place as the good service can be provided only by presenting it when requesting the repair.

1. The warranty benefits for this product are as listed on the warranty certificate.
2. The free-repair warranty period and quality warranty period are calculated from the date of purchase, so make sure to have the purchase date written down.(If the purchase date cannot be specified, it is presumed to be 3 months after the date of manufacture or import customs date.)
3. If using the household product for the sales purpose or means, or if using it in an abnormal environment, the free-repair warranty period is reduced to 50%.
4. Warranty certificate is not issued again.
5. When supplying under a separate contract, the warranty is applied according to the main contract.
6. The product quality warranty period is different from the free repair warranty period and it means the warranty period below.
 - As of the initial purchase date after product exchange
 - The battery warranty period is the period when free battery exchange is available.

Others

Guide for charged services (borne by customers)

When requesting the services, for the cases as below, you will be charged even if it is during the warranty period.

- If a failure occurs by putting in a foreign substance (water, beverage, coffee, toy, etc.)
- If the product damage and functional failure have occurred due to drop or impact.
- If the product appearance has been damaged or deformed due to use of organic solvents such as thinner and benzene.
- If the product failure occurs due to use of non-genuine parts or consumables other than those of CELLRETURN.
- If the product consumables have been lost or damaged due to random disassembly of the product by a customer.
- If a failure occurs due to misapplication of an operational voltage.
- If a failure occurs due to repair or modification of the product by a person other than the CELLRETURN service center's technician.
- If a failure occurs due to natural disasters (lightning, fire, damage from storm and flood, gas, damage from sea water, earthquake)
- If a failure occurs when "Precautions on Safety" in the user manual of the CELLRETURN product are not observed.
- If the product failure occurs due to other customer negligence.

* The user manual may be subject to change depending on the company situation.

MEMO

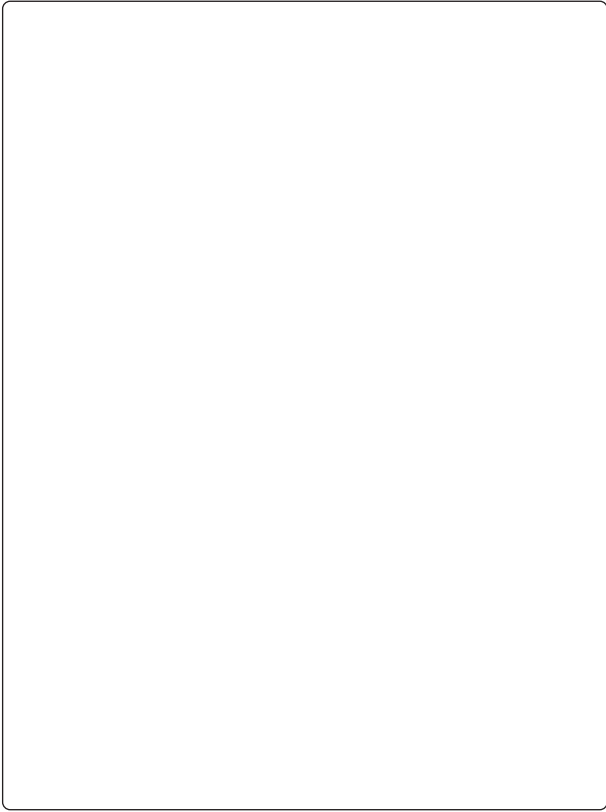

MEMO

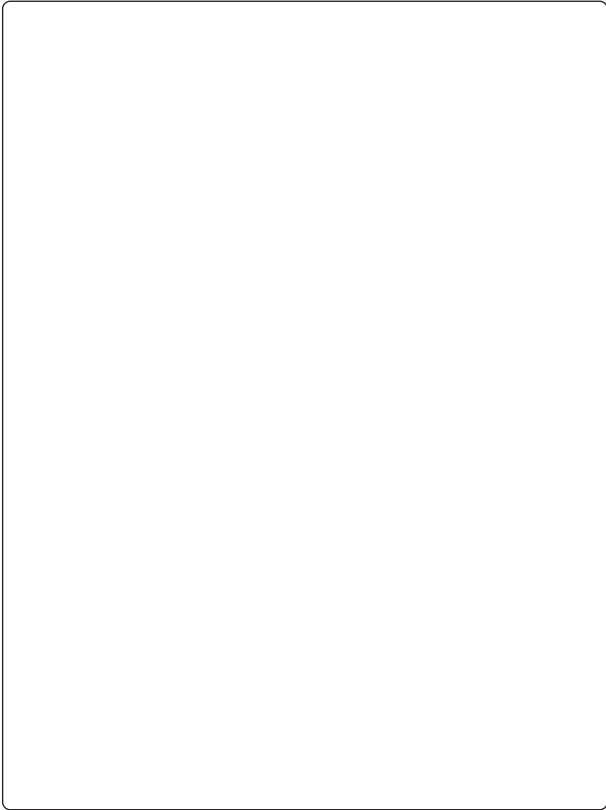

MEMO

A large, empty rectangular box with a thin black border, intended for writing a memo. The box is centered on the page and occupies most of the vertical space below the 'MEMO' header.



CELL RETURN

CELLRETURN CO.,Ltd

Address: 237, Namdongseo-ro, Namdong-gu, Incheon

[Postal Code: 21634]

Tel.1688-1026 Fax. 032-714-3895 E-mail : support@cellreturn.com

Copyright © 2020 CELLRETURN. All Rights Reserved.