



Welcome to the Loop Station!

The RC-1 is a pedal-type recorder that lets you record audio phrases from your guitar or bass, and play them back by operating the pedal. You can create a wide variety of performances by layering sound while you record and carry out play back in real time.

- It's easy to create a loop phrase.
- You can record up to a maximum of approximately 12 minutes (stereo).
- You can input audio in stereo.

Panel Descriptions

DC IN jack

Accepts connection of an AC Adaptor (PSA series; optional). By using an AC Adaptor, you can play without being concerned about how much battery power you have left.

- \* Use only the specified AC adaptor (PSA series; optional), and connect it to an AC outlet of the correct voltage. Do not use any other AC adaptor, since this may cause malfunction.
- \* If the AC adaptor is connected a battery is installed, the power supply is drawn from the AC adaptor.
- \* We recommend that you keep batteries installed in the unit even though you'll be powering it with the AC adaptor. That way, you'll be able to continue a performance even if the cord of the AC adaptor gets accidentally disconnected from the unit.

LEVEL knob

This adjusts the volume level of the loop phrase being played back.

- \* The input level from the INPUT jacks cannot be adjusted.

OUTPUT jacks A (MONO)/B

Connect these jacks to your amp or monitor speakers.

- If you're using a mono setup, use the OUTPUT A jack.
- \* **The OUTPUT A jack also operates as a power switch.** The power will be on if a plug is inserted in the OUTPUT A jack. Remove the plug when you're not using the RC-1.
- \* Do not connect headphones to the OUTPUT jacks. Doing so may damage the headphones.

Pedal switch

This pedal switches you between phrase recording, overdubbing, and playback. Press the pedal twice in succession to stop playback.

If you hold down the pedal two seconds or longer while stopped, the recorded phrase is erased.

Thumbscrew

When this screw is loosened, the pedal will open, allowing you to change the battery.

- \* For instructions on changing the battery, refer to "Changing the Battery."

CHECK indicator

This indicator shows the power on/off status, and also provides a battery check function.

- \* If you're powering the unit with a battery and the CHECK indicator goes dim—or doesn't light at all—the battery is near depletion and should be replaced. For instructions on changing the battery, refer to "Changing the Battery."

LOOP indicator

This lights during recording, overdubbing, and playback.

Indicator	Explanation
Red	During recording
Red and green	During overdubbing
Green	During playback

- \* During overdubbing/playback, the speed at which the indicator rotates corresponds to the length of the loop.

STOP/UNDO jack

If you connect a footswitch (FS-5U, FS-6, FS-7; sold separately), you can use it to stop playback or to undo/redo.

INPUT jacks A (MONO)/B

Connect your electric guitar, or another instrument or effect unit, to these jacks.

- \* Use the INPUT A jack and INPUT B jack when connecting a stereo-output effects unit. Use only the INPUT A jack if you're using a mono source.

Precautions When Connecting

- \* To prevent malfunction and equipment failure, always turn down the volume, and turn off all the units before making any connections.
- \* Raise the amp volume only after turning on the power to all connected devices.
- \* When operating on battery power only, the unit's indicator will become dim when battery power gets too low. Replace the battery as soon as possible.
- \* When connection cables with resistors are used, the volume level of equipment connected to the INPUT jacks may be low. If this happens, use connection cables that do not contain resistors.

Caution When Connecting an External Footswitch

You must power-off the unit before connecting an external footswitch. If you connect the footswitch while the power is on, recorded data might be lost.

Turning On the Power

Inserting a connecting plug into the OUTPUT A jack turns on the power to the unit. Once the connections have been completed, turn on power to your various devices in the order specified. By turning on devices in the wrong order, you risk causing malfunction and/or damage to speakers and other devices.

**When powering up:** Turn on the power to your guitar amp last.

**When powering down:** Turn off the power to your guitar amp first.

\* This unit is equipped with a protection circuit. A brief interval (a few seconds) after power up is required before the unit will operate normally.

\* Before turning the unit on/off, always be sure to turn the volume down. Even with the volume turned down, you might hear some sound when switching the unit on/off. However, this is normal and does not indicate a malfunction.

Caution when turning off the power

Never turn off the power while the LOOP indicator is rotating or blinking (i.e., don't pull the plug out of the OUTPUT A jack). The recorded data might be lost if you do so.

Basic Operation

To perform recording, overdubbing, and playback, press the pedal as shown in the diagram.

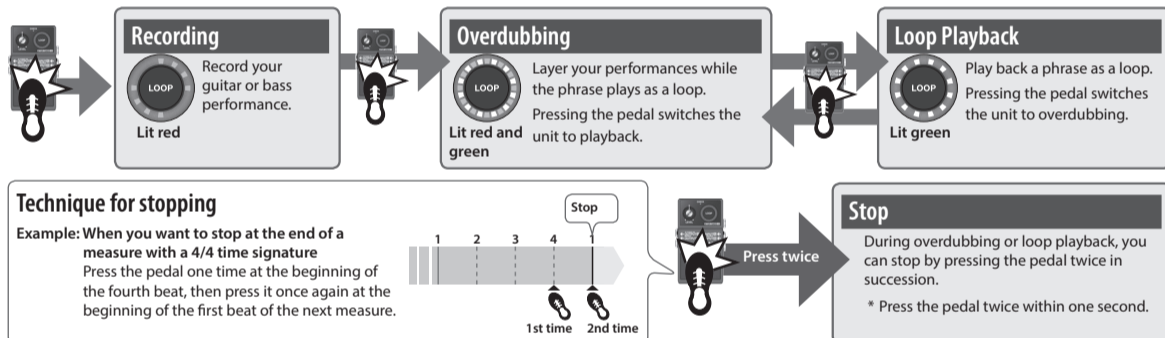

MEMO

- If a footswitch is connected to the STOP/UNDO jack, you can stop by pressing the footswitch just once.
- The recorded phrase is saved even if you turn off the power.

NOTE

- The minimum recording time for a loop phrase is approximately 0.25 seconds. If you press the pedal within approximately 0.25 seconds after you start recording, recording will continue until the phrase is at least approximately 0.25 seconds long.
- The maximum recording time for a loop phrase is approximately 12 minutes (stereo). If you exceed the maximum recording time, recording or overdubbing is interrupted, and operation changes to loop playback.
- Roland assumes no liability concerning the restoration of any stored content that has been lost.

Deleting a Phrase

The recorded phrase is erased if you hold down the pedal for two seconds or longer while stopped. During erasure, the LOOP indicator (red) blinks rapidly.

- \* Never turn off the power while the LOOP indicator (red) is blinking rapidly. The recorded data might be lost if you do so.
- \* The phrase plays while you hold down the pedal. If you want to erase the phrase without playing it, use an external footswitch to stop the phrase.

Cancelling an Overdub (Undo/Redo)

You can undo/redo by holding down the pedal for two seconds or longer during overdubbing or playback.

Operation	Explanation
Undo	Cancels the last recording or overdub.
Redo	To bring back the cancelled sound, hold down the pedal once again for two seconds or longer during playback. * Redo is possible only during overdubbing or playback.

During undo/redo, the LOOP indicator (green) blinks rapidly.

Connecting to an External Footswitch

Connect your footswitch to the STOP/UNDO jack as shown in the illustration, and set its POLARITY switch.

- \* The FS-5L cannot be used.

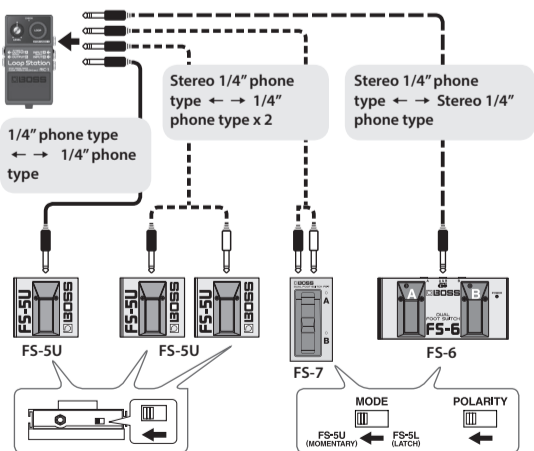

Footswitch	Operation
FS-5U	Stop
FS-5U/FS-7 pedal connected to the stereo L side	During recording/overdubbing/playback, press the footswitch to stop.
FS-6's pedal B	Hold down the footswitch two seconds or longer to erase the phrase.
FS-5U/FS-7 pedal connected to the stereo R side	Undo/Redo
FS-6's pedal A	You can undo/redo by pressing the footswitch.

Changing the Recording Mode or Stop Mode

1. While holding down the pedal switch, turn the power on (insert a plug into the OUTPUT A jack). The LOOP indicator (red) lights, indicating the current recording mode.

Recording mode	Explanation
Red Upper half	Switch in the order of recording → overdubbing → playback (default setting).
Red Lower half	Switch in the order of recording → playback → overdubbing.

2. Press the pedal switch successively twice (within one second) to change the recording mode.
3. Press the pedal switch. The LOOP indicator (green) lights, indicating the current stop mode.

Stop mode	Explanation
Green Upper half	Press the pedal switch successively twice to stop immediately (default setting).
Green Lower half	Press the pedal switch successively twice to enable stopping at the end of the phrase; playback stops when the phrase has played to its end. When playback stops, the phrase is erased. <b>Operation when stop has been enabled</b> • The LOOP indicator (green) rotates while blinking. • Press the pedal switch successively twice to stop immediately and erase the phrase. • Hold down the pedal switch for two seconds or longer to cancel the stop-enabled state.

4. Press the pedal switch successively twice (within one second) to change the stop mode.
5. When the power is turned off and on again, the unit returns to normal operation.

Changing the Battery

1. Hold down the pedal and loosen the thumbscrew, then open the pedal upward.  
\* The pedal can be opened without detaching the thumbscrew completely.
2. Remove the old battery from the battery housing, and remove the snap cord connected to it.
3. Connect the snap cord to the new battery, and place the battery inside the battery housing.  
\* Be sure to carefully observe the battery's polarity (+ versus -).
4. Slip the coil spring onto the spring base on the back of the pedal, and then close the pedal.  
\* Carefully avoid getting the snap cord caught in the pedal, coil spring, and battery housing.
5. Finally, insert the thumbscrew into the guide bush hole and fasten it securely.

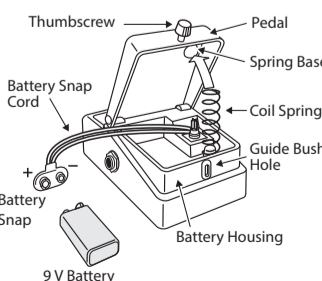

Specifications

BOSS RC-1: Loop Station

Nominal Input Level	-20 dBu
Input Impedance	1 MΩ
Nominal Output Level	-20 dBu
Output Impedance	1 kΩ
Recommended Load Impedance	10 kΩ or greater
Maximum Recording Time	Approx. 12 minutes
Power Supply	DC 9V: Alkaline battery (9V, 6LR61), AC Adaptor (PSA series; sold separately)
Current Draw	95 mA * Expected battery life under continuous use: Alkaline: Approx. 3 hours These figures will vary depending on the actual conditions of use.
Dimensions	73 (W) x 129 (D) x 59 (H) mm 2-7/8 (W) x 5-1/8 (D) x 2-3/8 (H) inches
Weight	440 g/1 lb (including battery)
Accessories	Owner's Manual, Leaflet ("USING THE UNIT SAFELY," "IMPORTANT NOTES," and "Information"), Alkaline battery (9V, 6LR61)
Options (sold separately)	AC adaptor: PSA series Footswitch: FS-5U, FS-6, FS-7

\* 0 dBu = 0.775 Vrms

\* In the interest of product improvement, the specifications and/or appearance of this unit are subject to change without prior notice.

About the Battery

- Batteries should always be installed or replaced before connecting any other devices. This way, you can prevent malfunction and damage.
- The use of an AC adaptor is recommended as the unit's power consumption is relatively high. Should you prefer to use battery, please use the alkaline battery.
- If you handle batteries improperly, you risk explosion and fluid leakage. Make sure that you carefully observe all of the items related to batteries that are listed in "USING THE UNIT SAFELY" and "IMPORTANT NOTES."

Repairs and Data

- Although we will do our utmost to preserve the data stored in your unit when we carry out repairs, in some cases, such as when the memory section is physically damaged, restoration of the stored content may be impossible. Roland assumes no liability concerning the restoration of any stored content that has been lost.

Intellectual Property Right

- It is forbidden by law to make an audio recording, video recording, copy or revision of a third party's copyrighted work (musical work, video work, broadcast, live performance, or other work), whether in whole or in part, and distribute, sell, lease, perform, or broadcast it without the permission of the copyright owner.
- Do not use this product for purposes that could infringe on a copyright held by a third party. We assume no responsibility whatsoever with regard to any infringements of third-party copyrights arising through your use of this product.
- Roland, BOSS, and Loop Station are either registered trademarks or trademarks of Roland Corporation in the United States and/or other countries.
- Company names and product names appearing in this document are registered trademarks or trademarks of their respective owners.