

# Richard P. Welsh LIBRARY

 **NEWSCHOOL**  
OF ARCHITECTURE & DESIGN

**2022-2023**





# Contents

<b>Introduction</b>	3
Mission	
Learning Outcomes	
<b>Finding Information</b>	4
Library Map	
Dewey Decimal Subject Guide	
Website	
Catalog	
LinkedIn Learning	
Databases	
Periodicals	
Thesis	
Additional Holdings	
<b>Using the Collection</b>	10
Printing etc.	
Lenz Lab	
Borrowing	
Returning	
Fines	
Requesting	
<b>Facilities</b>	12
Access	
Hours	
Workspaces/IT Facilities	
The Loft	
<b>Connecting</b>	14
Displaying Student Work	
Lost and Found	
Ask a Librarian	

## Introduction

This guide to the Richard P. Welsh Library at NewSchool of Architecture and Design will help you find your way around and familiarize you with our services.

The library is a well-stocked academic library with access to diverse e-resources including eBooks, online magazines, databases, and streaming videos. The library also maintains print collections of over 17,000 volumes, course reserves, print magazines and a variety of technology and craft supplies.

The library has continued to grow and develop throughout the life of the school. Make sure to check out our collection of design chairs! In addition to books and study space, the library offers campus networked computers; scanning, printing, Wi-Fi throughout, outlets, charging stations, and space for group and private study.

## Mission

**The mission of the Richard P. Welsh Library is to support the teaching and research needs of the faculty, students and alumni of the NewSchool of Architecture & Design.**

## Learning Outcomes

Library users will be able to:

- Locate and access resources utilizing appropriate search strategies within the library and beyond.
- Critically evaluate information sources considering relevance, reliability, and authority.
- Use information ethically and legally assigning credit for the source and ideas utilizing pertinent citation standards.
- Apply discipline-specific research methods to accomplish a particular purpose.



# Finding Information

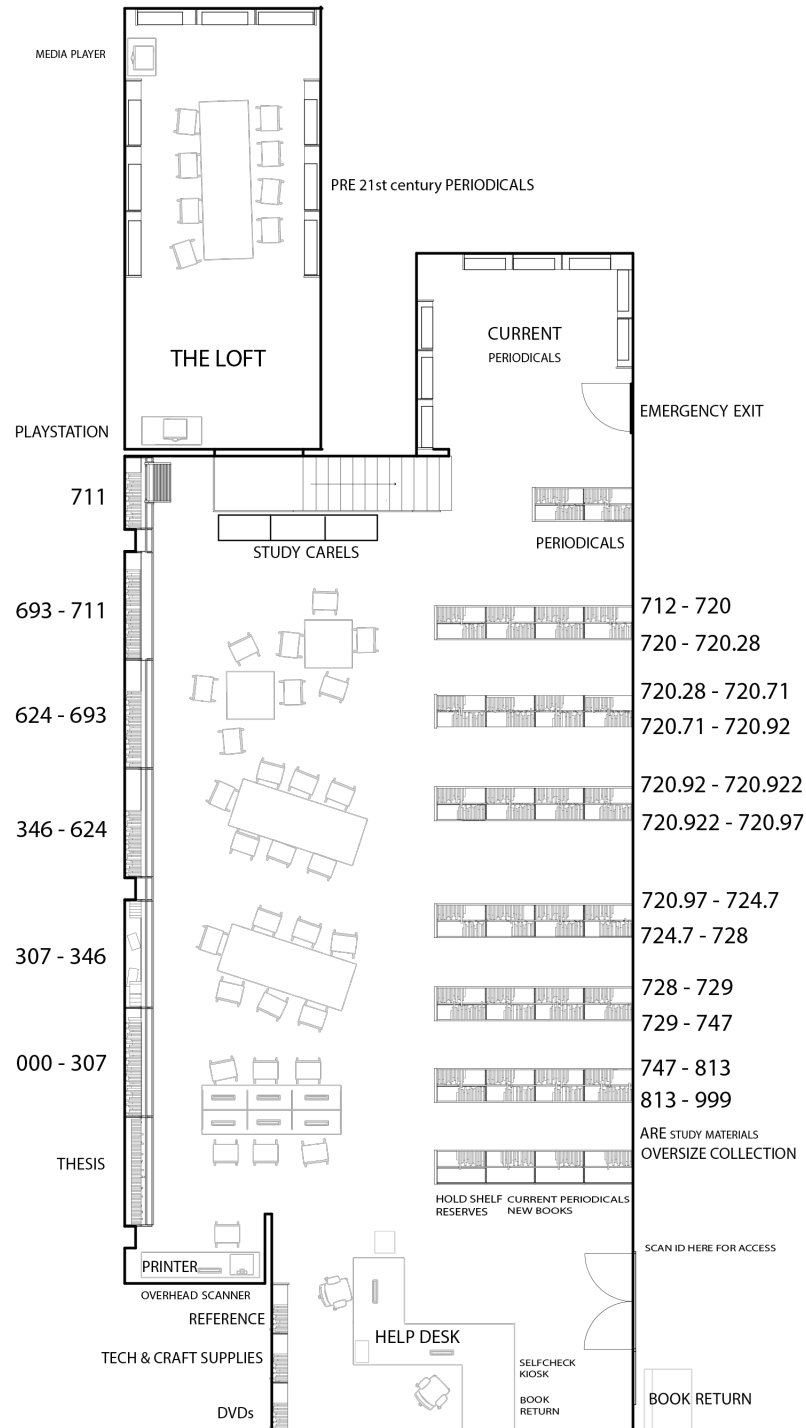

## Dewey Decimal Subject Guide

The Dewey Decimal System classifies books and assigns them a number from 0-999 based on subject. Books are shelved in ascending order from left to right. Architecture and Design is found primarily in the 700's, so a large portion of our collection is focused here. This quick subject guide will help you get started looking for what you need. Often simply browsing the shelves in your area of interest can uncover new and useful resources.

307 - 308

343

658.404

690 - 699

700 - 710

711

712 - 719

720.1 - 720.108

720.2 - 720.284

720.4356

720.47 - 720.473

720.92 - 720.922

721.044

722-724

725 - 728

728.370222

741

747

urban planning

construction law

project management

building and construction

art

urban planning

landscape architecture

architectural theory

architectural drawing / modeling

neuroscience for architecture

sustainable architecture

individual architects / firms

specific materials

architectural schools/ styles

building typologies

tiny houses

graphic design

interior architecture and design



## The Library Website

[library.newschoollarch.edu/home](http://library.newschoollarch.edu/home)

From our homepage you can access your account, renew materials, search the library catalog, access our e-resources, and contact us for help. The website also has subject guides for everything from homelessness and architecture to portfolio design.

## The Library Catalog

[library.newschoollarch.edu/catalog](http://library.newschoollarch.edu/catalog)

The online catalog of the Richard P. Welsh Library allows you to search physical collections and eBooks. Records contain the status of each book (checked out/ available) and the call number to find it on the shelves. The catalog is publicly accessible, and you can login to reserve and renew books. For more information consult library staff.

## LinkedIn Learning

[library.newschoollarch.edu/linkedinlearning](http://library.newschoollarch.edu/linkedinlearning)

LinkedIn Learning offers online courses on design software, creativity, and business skills. Earn certificates in new design programs. Sign in with your O365 credentials.

## Databases

[library.newschoollarch.edu/az](http://library.newschoollarch.edu/az)

Find scholarly sources online through our website. In addition to academic peer-reviewed full-text publications we subscribe to video streaming services via Kanopy.



# Periodicals

[library.newschoolarch.edu/home/magazinesandjournals](http://library.newschoolarch.edu/home/magazinesandjournals)

The library subscribes to 30 print and thousands of digital periodicals. New print issues are displayed by the library entrance. If you are looking for a specific issue or title please contact library staff.

## Thesis

Past graduate and undergraduate thesis and capstone projects are available in the library. Student work prior to 2000 is held in storage. Student work from 2016 and beyond is available digitally.

[View Digital Thesis](#)

## Library Things

We offer flash drives, headphones, calculators, and chargers at the library desk. Because design students pursue research through a variety of methodologies., we also offer a growing range of non-traditional research tools.

- Arduino Kit
- Craft Knife Kit
- Game Controllers
- Legos
- MAVIC Drone
- Modelling Kit
- Mola Structural Kit
- Nikon DSLR Camera
- Oculus Rift Headset
- Sculpting Kit
- Snowball USB Microphone
- Wacom Digital Sketching tablets
- And more!



# Using the Collection



## Borrowing

NewSchool students, faculty, staff and alumni, and members of the San Diego Chapter of the American Institute of Architects (AIA) are automatically granted the following borrowing rights.

Books	3 weeks
New Books	2 weeks
Magazines & Tech	1 week
Thesis Books	1 week
Reference & Reserve	2 hours

Items can be checked out with staff at the library desk, or via the self-check kiosk. Up to 20 items may be borrowed concurrently. Unless requested by another patron, items can be renewed three times. You can renew online via the library catalog, at the library desk, or by contacting library staff.

## Printing

The library has a black and white printer and an overhead scanner for high resolution image capture. Two multi-function copiers, printers and scanners are located in the student lounge. Users are reminded of the restrictions on photocopying which are defined by the Copyright Law of the United States. Details are posted by all copiers.

## Photo Studios

The campus has two architecture and design photo studios that are open to students the same hours as the campus. Students can check out a tripod, phone mount, and DSLR camera from the library desk. Please treat all equipment respectfully and return the studio to its original condition when you are finished.

## Returning

Items can be returned at the desk or placed in book drops located at the library desk and outside the library entrance.

## Fines

To make your library experience inclusive, accessible, and positive, we have removed late fines on most library materials. Fines still apply for course reserves, and replacement costs are charged for lost or damaged items. Keep in mind unreturned library materials will place a hold on your account that prevents registration.

## Requesting

You can request books that are already on loan to someone via the library catalog or by contacting library staff. You will be contacted via email to let you know when the book is available. Holds expire after two weeks.



# Facilities



## Access

Scan your ID for access outside of staffed hours. The library is open to the wider academic community and the general public. Library staff may ask to see your student ID whenever you are in the library, so please keep it safe.

## Hours

During Term	
Staffed: Monday - Friday	9 am - 8 pm
Open: Daily	7 am - 10pm
Breaks	
Staffed: Monday - Friday	9 am - 5 pm
Open: Daily	7am - 10pm
Closed	
New Year's Day	Labor Day
Martin Luther King Jr. Day	Veteran's Day
President's Day	Thanksgiving
Memorial Day	Day After Thanksgiving
Independence Day	Christmas Day

Students and faculty will be notified of additional closures. Summer term hours are subject to change. Please check with library staff.

Library staff notify users 5 minutes prior to closing time. Please be aware of library closing times and be ready to leave.

## The Loft Study Space

The loft provides space for group study. The room seats up to 12 people and is available during regular opening hours. You can reserve the space by contacting library staff.

## Workspaces & IT Facilities

The library provides 42 workspaces. Outlets are available for laptops and charging. Seven networked computers are available in the library. WiFi is available throughout the library. Ask library staff for assistance.

# Connecting with the Library



instagram: @newschoollibrary



youtube channel: NSADlibrary

## Displaying Student Work

We love to display the creative works our students create. If you or your class have models or prototypes to display bring them to the library desk.

## Lost & Found

NewSchool's lost and found is located at the library desk. We keep items locked and secure so if you've lost anything, ask us! If we don't already have it, we'll contact you if it turns up.

## Ask a Librarian

Need some help finding resources or defining your research topic? Email us at [library@newschoolarch.edu](mailto:library@newschoolarch.edu) or call/ text (619) 684-8783. You can also [book an appointment with us](#). We are here to help!





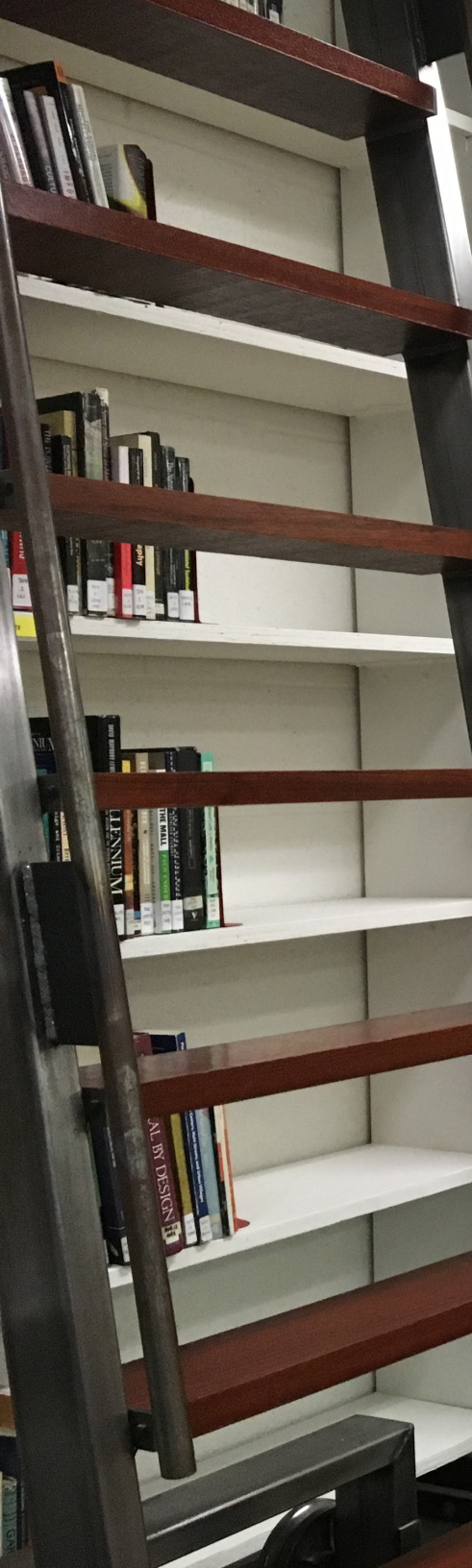

Richard P. Welsh  
LIBRARY

1249 F Street  
San Diego CA, 92104  
(619) 684-8783

[library@newschoolarch.edu](mailto:library@newschoolarch.edu)