

Mopping Robot

User manual

VR20T6001M* Series

- Before operating this unit, please read the instructions carefully.
- For indoor use only



SAMSUNG

User manual

Please read this manual carefully before operating Mopping Robot. Note that this manual also includes the Warranty Card, so please store in a convenient location for future use.

Mopping Robot is not designed for Industrial or Commercial use.

Please fully charge the battery before first use. Samsung assumes no responsibility for technical or editorial errors or omissions contained herein, nor for any incidental or consequential damages and failures of appliance caused by not following the precautions and instructions.

Contents

Safety information	3	Cleaning modes	11
Parts name & Product component	5	Handy Cleaning mode & Product maintenance	12
Charging status & Indication.	7	LED indications	13
Installing the water supply mop kit . . .	8	Troubleshooting.	14
Water supply mop kit & Mop maintenance.	9	Product Specifications.	15
Cleaning operation & Remote control. .	10		

Safety information

The following content provides important information in using Mopping Robot correctly, and preventing damage or danger to user.

Samsung assumes no responsibility for technical or editorial errors or omissions contained herein, nor for any incidental or consequential damages and failures of appliance caused by not following the precautions and instructions.

Warning

- Do not use power cord if it is damaged. Please contact a Samsung Authorized support facility to repair or replace the damaged power cord.
- When plugging in or removing the power plug, always plug it in or remove it by holding the plug, not via the cable. Do not use a damaged power cord or plug.
- Do not touch the plug or wall socket with wet hands.
- Do not operate the Mopping Robot in rooms with temperatures below 5 °C/41 °F or higher than 40 °C/104 °F.
- Please keep loose clothing or hair away from rotating mop pads.
- Do not use or store the robot cleaner near flammable materials (alcohol, gasoline, kerosene, thinner, etc.) or heating sources. (Cigarettes, candles, stove, etc.)
- If you notice smoke or a burning smell or an unusual sound from the robot cleaner, immediately turn off the power and contact a local Samsung service center.
- Do not disassemble Mopping Robot. If it is not working properly, please contact a local Samsung service center.
- This appliance is not intended for use by persons (including children) with reduced physical, sensory, or mental capabilities, or lack of experience and knowledge, unless they have been given supervision or instruction concerning use of the appliance by a person responsible for their safety. Children should not clean or perform maintenance on Mopping Robot without adult supervision.
- Do not use Mopping Robot near a heater or combustible materials.
 - Do not use Mopping Robot near fire or flame such as a movable heater, a candlelight, a desk lamp, a fireplace etc. or in a place where combustible materials such as, gasoline, alcohol, thinner etc. exist.

Caution

- Before using Mopping Robot, please clear the area and remove any objects that may impede or block the cleaning process.
- Do not soak Mopping Robot in water or spray oil on it.
- Do not use Mopping Robot on a table or other high places.
- Mopping Robot may not be able to see objects that are below its sensors. This may impact its ability to detect stair edges or other steep drops.

- Remove and allow mop pads to dry after use. Do not leave wet mops on floors for an extended period of time, as you risk damaging your floors.
- Make sure that children or pets do not step or sit on the robot cleaner while operating.
- Mopping Robot is designed for indoor usage.
- Power off Mopping Robot whenever you are switching cleaning pads or adding water to the mop kits.
- Make sure the sensor windows are clean and obstruction free prior to use.
- Make sure the water supply mop kit is filled with water and assembles to Mopping Robot before use.
- Do not use Mopping Robot on black colored floors.
 - Mopping Robot may not be able to operate normally.
- The cliff detection sensor may not detect a height difference less than 50 mm, and therefore the product may fall. Be cautious when using the product.

Note

- Do not use the robot cleaner on a floor with a slope greater than 10°.
- Make sure the Mopping Robot battery is fully charged before each use.
- Remove obstacles (chair, etc.) for quick and thorough cleaning.
- After using the water supply mop kit and wet mop, clean them thoroughly.
- If Mopping Robot equipped wet mops are put on the floor plate for long time, the mops may be contaminated.
- Remove the protective film from the product before use.

State of California Proposition 65 Warning (US only)

WARNING

This product contains chemicals known to the State of California to cause cancer and birth defects or other reproductive harm.



For battery recycling go to call2recycle.org
or call 1-800-822-8837



How to use Mopping Robot

Parts name & Product component

Components

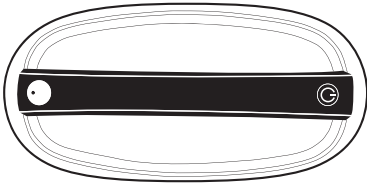

Main unit

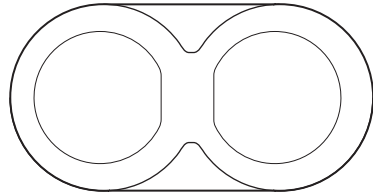

Floor plate

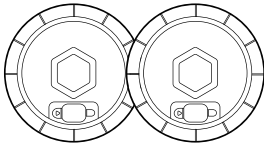

Water supply mop kit

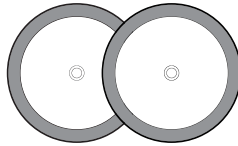

Mother yarn mop
(Gray color)

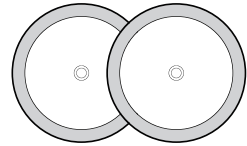

Microfiber mop
(Green color)

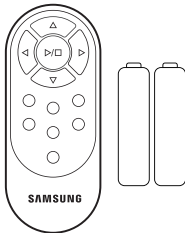

Remote control (with
battery)

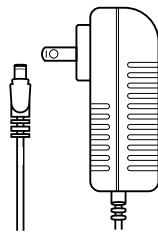

Power adapter

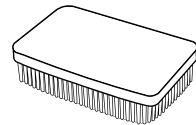

Silicone brush



Note

Mother yarn mop (Gray color)

Mother yarn is 100x thicker than microfiber, ideal for cleaning dust in cracks and picking up spills.

Microfiber mop (Green color)

It is a mop with richer and longer yarns for a superior wiping performance.

Main unit / Front

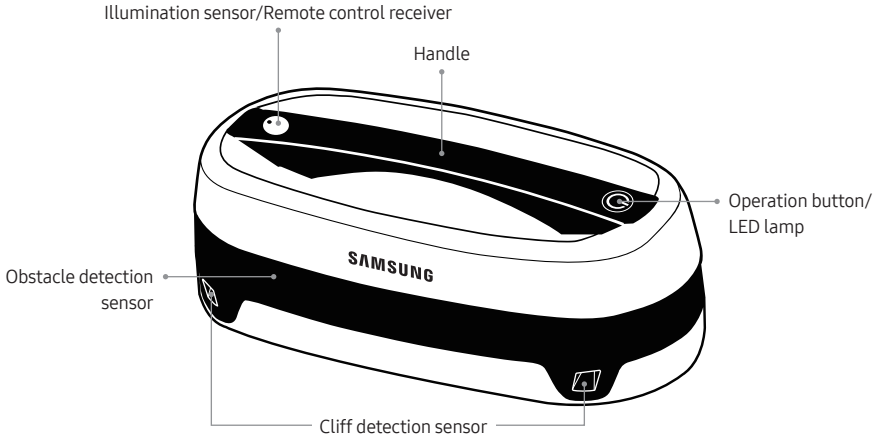

Main unit / Bottom

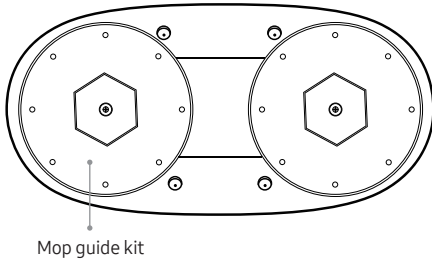

Main unit / Rear

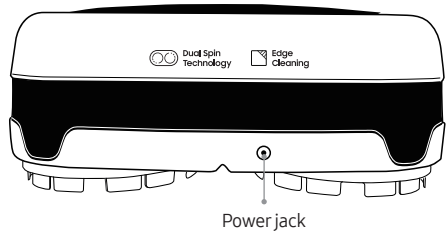

Water supply mop kit / Top

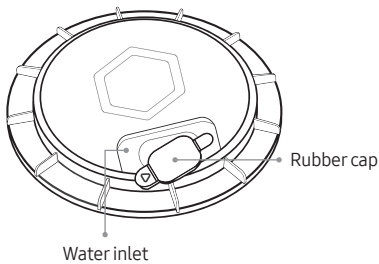

Water supply mop kit / Bottom

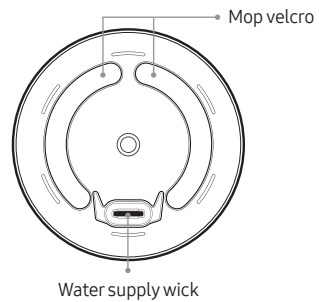

Charging status & Indication



Caution

- Only use authorized adapter. Or, it may cause serious damage to the product.
- Do not charge the non-rechargeable batteries.

How to charge

Connect the power adapter to the charging port on the back of main unit.

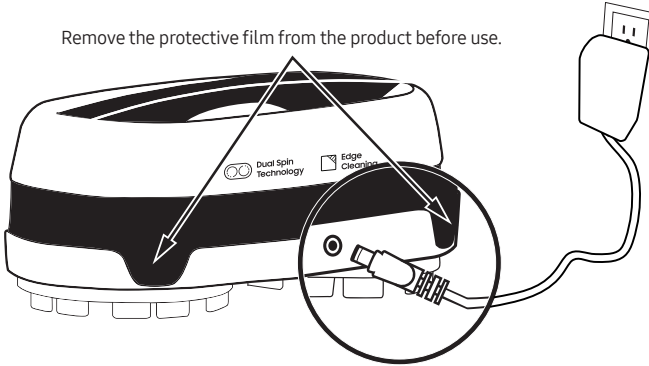

Remove the protective film from the product before use.

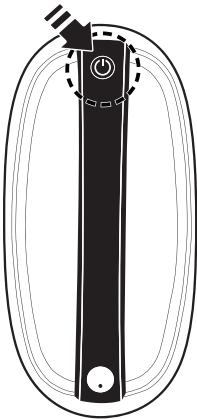

Battery level indication

Battery level can be checked through LED lamp.



 Yellow	Yellow Blinking	Low battery
 Blue	Blue Blinking	Battery more than 80 %
 OFF	LED Off	Fully charged
Charging time: About 100 min (In case of full discharge, 150 min). Operating time: About 100 min (operating time may vary depending on floor condition).		

Installing the water supply mop kit



Caution

- Please disconnect and power off the Mopping Robot when you install or detach the water supply mop kits.
- Please wring the water out of the mops prior to use, otherwise the cleaning process may slow down.
- Make sure to fill the water supply mop kit before use. Using the product without water in the water supply mop kit may cause static electricity.

How to install the water supply mop kit



1 Wet mops thoroughly with clean water, then wring water out.

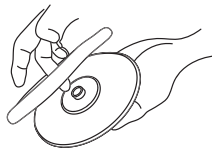

2 Attach the mop pads to the water supply mop kit. (See the figure above.)



3 Open the rubber cap of the water supply mop kit.



4 Fill the water supply mop kit with clean water.

* Water only

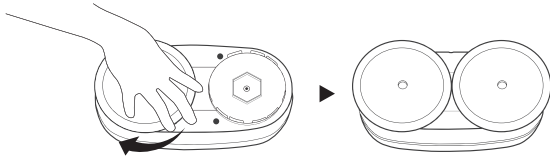

5 Close the rubber cap of the water supply mop kit and attach to the bottom of the main unit. (Pressing down while gently turning side to side. You will hear a click when they attach.)

Caution

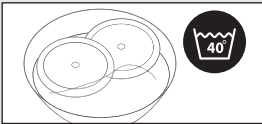

We recommend you wash the mops with detergent before first time use.

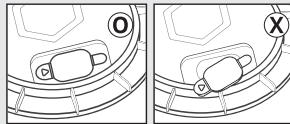

Correct

Wrong

Please make sure the rubber cap is fully closed after filling the water tank. Failure to close may result in product failure or malfunction.

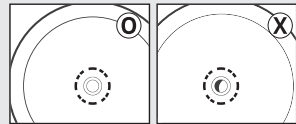

Correct

Wrong

When attaching the water supply mop kit to the main unit, refer to the figure above. The main unit will not work properly if they are not attached correctly.

Water supply mop kit & Mop maintenance

Washing the mops

You can use included silicon brush for easier mop washing.

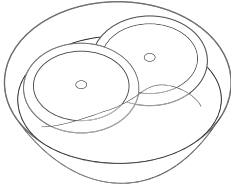

1 Wet mops thoroughly.

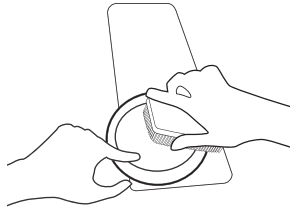

2 Use a natural detergent for washing mops.

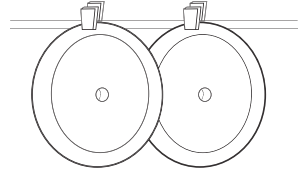

3 Squeeze out water and dry them under the sun light.

Maintaining the water supply mop kits

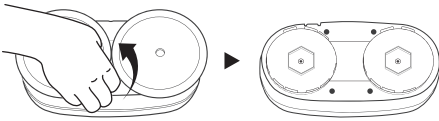

1 Separate the water supply mop kit from the main unit when cleaning operation is finished.

- Pull out the water supply mop kit by hands.
- If it is hard to pull out, twist it a little bit.

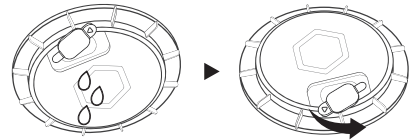

2 Open the rubber cap and pour out any remaining water from the water supply mop kit.



Note

If the water supply is not working well, wash the water supply wick, as per the following pictures.



Caution

Remove and allow the mop pads to dry after use. Do not leave wet mops on floors for an extended period of time, as you risk damaging your floors.

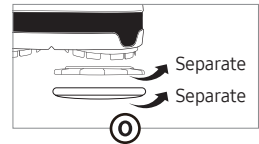
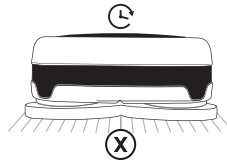

Cleaning operation & Remote control



Do not use the main unit without the water supply mop kit, as it may damage the device.

Start cleaning

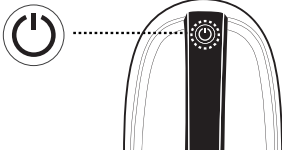

- 1 Press and hold the Operation button for 2 seconds until it beeps and the light stays on.

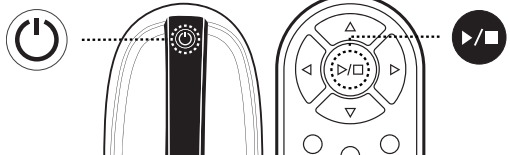

- 2 To start cleaning, either press the Operation button on the main unit, or press the Start/Stop button on the remote control.



- Stop the cleaning process by either pressing the Operation button on the main unit or the Start/Stop button on the remote control.
- The main unit will turn itself off after 5 minutes of inactivity. You will need to turn it back on if you want to start cleaning.

Remote control

The range of remote control is max. 16 ft (5 m)

Start/Stop
Start the auto cleaning or stop the cleaning mode.

Edge
Focuses on cleaning corners and edges of floor.

Auto
Basic cleaning mode that effectively cleans the whole area.

Intensive
Intensively cleans with straight and circling moving patterns.

Pattern
Thoroughly clean with curve pattern as if wiping the floor by hand.

Direction
When the main unit stops, the unit can be controlled with direction buttons.
* If the backward direction button (▽) is pressed, the main unit will turn 180° and go straight.

Focus
Intensively cleans the surrounding area relative to the main unit's current location.

Step
Cleans left to right moving forward in steps, similarly to how a human walks.

50min
Random cleaning only for 50 minutes. Good for a small room or isolated area.

Buttons on remote: Start/Stop, Edge, Auto, Intensive, Pattern, Direction (Up, Down, Left, Right), Focus, Step, 50min, SAMSUNG.

Cleaning modes



Select a cleaning mode you want by using the remote control.

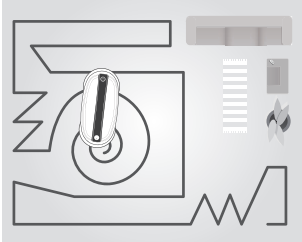

Auto

Basic cleaning mode that effectively cleans the whole area.

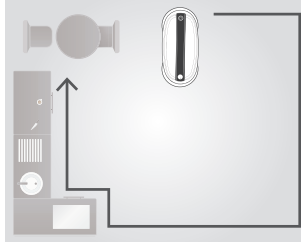

Edge

Focuses on cleaning corners and edges of floor.

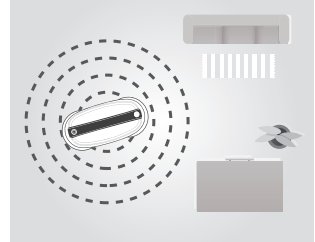

Focus

Intensively cleans the surrounding area relative to the main unit location.

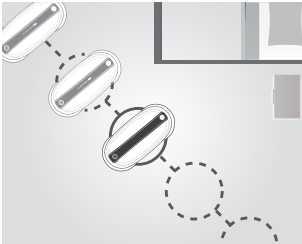

Intensive

Intensively cleans with straight and circling moving patterns.

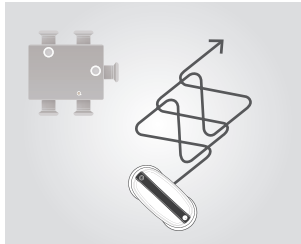

Pattern

Thoroughly clean with '∞' curve pattern as if wiping the floor by hands.

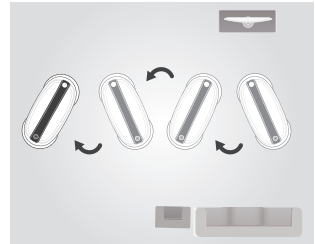

Step

Cleans left to right moving forward in steps, similarly to how a human walks.



50min

Random cleaning only for 50 minutes. Good for a small room or isolated area.

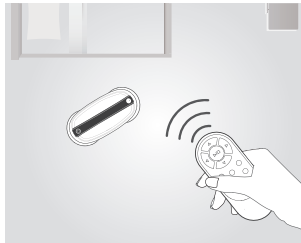

Manual

Cleans with direction button keys of remote control. Only moves when the direction button is pressed.

Handy Cleaning mode & Product maintenance



Note

- User can clean manually by holding the handle of the main unit.
- This mode is good to clean desks, tables, glass floors, and glass windows.

How to use Handy Cleaning mode

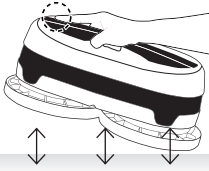

Lift the main unit by the handle, and press the Operation button twice quickly.

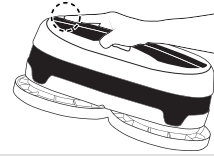

Press the Operation button if you want to stop the Handy Cleaning mode.



Caution

- To start the Handy Cleaning mode, make sure to hold the main unit sufficiently away from any surrounding surface before pressing the operation button twice quickly.
- When operating in the Handy Cleaning mode, all sensors are turned off.
- Do not place the main unit on the floor, table, or next to stairs, as it will bump against walls without turning around and will not sense edges/drops, leading to product damage.
- To exit the Handy Cleaning mode, press the Operation button on the main unit or Start/Stop button on the remote control.

Cleaning sensors

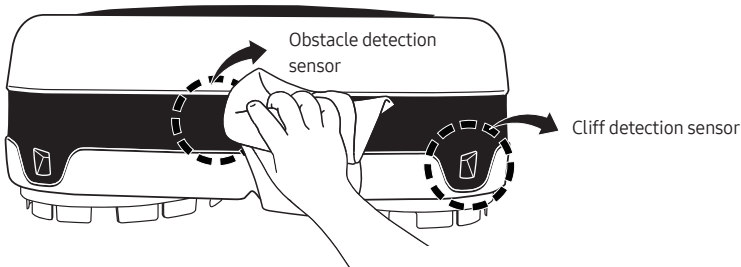

Clean obstacle detection sensors by gently wiping with a cotton swab or dry cloth.







Caution



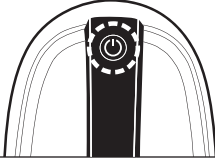

Do not use benzene or alcohol to clean sensors.

LED indications

Description of LED lamp



When charging		
 Yellow	Yellow Blinking	Not enough battery
 Blue	Blue Blinking	Battery is more than 80%
 OFF	LED Off	Fully charged

When using		
 Blue	Blue Blinking	<ul style="list-style-type: none"> Change mops, and fill water in the water supply mop kit and start the cleaning again.
 Yellow	Yellow On	<ul style="list-style-type: none"> Recharge the battery. * If the battery is low while cleaning a dark place, the unit moves out to a bright place and stops operation.
 Yellow	Yellow Blinking	<ul style="list-style-type: none"> Check whether the unit stopped due to an obstacle. Check whether there are foreign substances in the mop guide kit or water supply mop kit. Operate the unit in a wide place again after turning the power switch off and back on.
 Red	Red Blinking	<ul style="list-style-type: none"> Check whether the authorized adapter was connected to the main unit. Turn off the main unit, and then turn it on again. Then, restart cleaning. If the same symptom is repeated, turn off the power. Then, contact a local Samsung service center.
 OFF	LED Off	<ul style="list-style-type: none"> The main unit is turned off.



Note

- When there is an error, the main unit will stop and sound the alarm for 5 minutes while LED blinks.
- After the alarm sounds and the LED blinks 10 times, the unit will power off after a few minutes.

This is NOT a malfunction. Please check.

■ LED lamp is off.

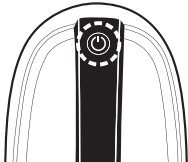

LED Off

If the machine is not used for 5 minutes, it will automatically turn itself off and the LED will go out.

LED On

If you press the Operation button for 2 sec, the LED will turn on, indicating unit is ready for use.

■ Alarm sounds while operating.



Blue blinking

After 50 min. of cleaning, the main unit will stop and sound an alarm alerting user to add water to the water supply mop kit.

For better cleaning, we recommend you recharge the unit and replace with new, clean mops.

Troubleshooting

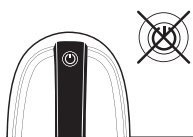

The unit does not turn on.

- The battery may not be charged.
- Recharge the battery fully and start the main unit again.

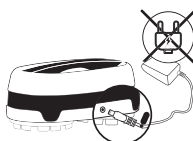

The main unit does not charge.

- Check if the power adapter is correctly connected.

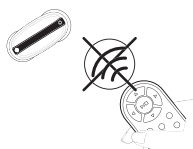

Remote control does not work.

- Check if the main unit is turned on.
- Replace the remote control batteries with new ones.
- The remote control does not operate while the main unit is recharging.
- Check that the main unit is within range of the remote control (16 ft/5 m).

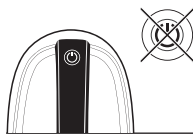

The main unit does not work.

- Check if the main unit is powered on.
- Press the Operation button for 2 sec. And check if it is turned on.
- Check battery level or errors through the LED lamp.

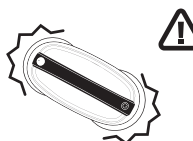

The movement of the main unit is abnormal during cleaning.

- Clean up the sensor windows. (refer to 12p)
- Check if the mops are properly attached on the mop kits.

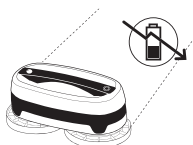

Driving or cleaning force is weak.

- Check if the water supply mop kit or the mops are installed correctly. (refer to pg 8)
- The product may get slower or the cleaning performance may decrease if the mops are too wet. In this case, wring the mops and restart the cleaning.
- Check if foreign substances like a long string are caught in the water supply mop kit or mop guide kit.
- Firmly tighten the screw of the mop guide kit on the bottom of the main unit. (refer to pg 8)
- The main unit is made to be operated in the home (floor) environments.



The operational noise is louder than normal.

- Check if any foreign substances are caught in the rotating plate of the main unit.
- Loose screw of the rotating plate may cause noise.

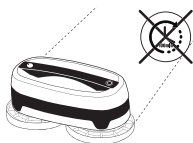

The operating time is short.

- Charge the battery until it is full.
- If the battery is completely discharged, operating time of the main unit may be shortened.
- Check if the LED lamp blinks red while charging.
- The LED lamp blinking red may be a sign indicating that battery is abnormal, so turn off and unplug the main unit. Then, contact a local Samsung service center.

Product Specifications

Main Unit

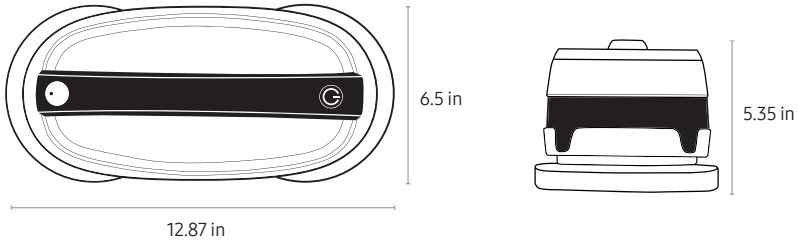

Product Name	Electric Floor Sweeper (Floor Mopping Robot Cleaner)		
Model Name	Mopping Robot	Power Consumption	27 W
Size	W12.87 x D6.5 x H5.35 in	Weight	3.5 lb
Power	100-240 V~, 50-60 Hz	Battery	Li-ion DC11.1 V, 2150 mAh
Operating Noise	63 dB (Auto Cleaning mode)	Operating Time	100 min
Driving Speed	20 cm/sec		

Remote Control

Product Name	IR Remote Control	Model Name	VR6000TM IR
Size	W5.90 x D1.97 x H0.83 in	Weight	0.10 lb
Signal Transmission Distance	Max. 16 ft/5 m	Battery	2 x AAA batteries

If you have any questions or comments relating to Samsung products, please contact a local Samsung service center.

Country	Customer Care Center	Web Site
CANADA	1-800-SAMSUNG (726-7864) 1-844-SAM-PAYS (726-7297)	www.samsung.com/ca/support (English) www.samsung.com/ca_fr/support (French)
U.S.A	1-800-SAMSUNG (726-7864) 1-844-SAM-PAYS (726-7297)	www.samsung.com/us/support

